

**Stantec Consulting Services Inc.**  
30 Park Drive, Topsham ME 04086-1737  
Phone: (207) 729-1199  
Fax: (207) 729-2715

This area is for special notes. Examples are:  
project name, project number, etc.

To: Tim Carr  
Company: Land Use Planning Commission  
Address: Tim.carr@maine.gov  
Phone: (207) 592-4129  
Date: March 7, 2023  
File: Wolfden Mt Chase, LLC. (ZP 779A)  
Delivery: Email

From: Brooke Barnes  
 For Your Information  
 For Your Approval  
 For Your Review  
 As Requested

**Reference: Errata for Attachment 6-A, Wetland and Watercourse Delineation and Potential Vernal Pool Survey Report (July 28, 2022)**

Attachment:

Copies	Doc Date	Pages	Description
1	March 7, 2023	4	Revised Table 1 correcting stream name typo in bottom right cell of page 6
1	March 6, 2023	1	Revised Figure 1, <i>Delineated Wetlands and Streams Map</i> , to show stream S12TT on north edge of rezone area

Hi Tim

As discussed, please find errata for the Pickett Mountain wetland report.

Best



**Brooke Barnes**  
Principal  
Stantec Consulting Services, Inc.

Phone: 207 406 5461  
Fax: 207 729 2715  
brooke.barnes@stantec.com

c. Jeremy Ouelette, Wolfden

WETLAND AND WATERCOURSE DELINEATION AND POTENTIAL VERNAL POOL SURVEY REPORT

Table 1. Summary of Delineated Wetlands

Wetland Resource Identifier	Wetland Classification <sup>1</sup>	Dominant Vegetation	Hydric Soil Criteria and Indicator	Evidence of Hydrology	LUPC Wetlands Protection District	Wetland of Special Significance (WoSS/P-WL1)	Additional Comments
W01TTA	PFO	<b>Trees:</b> yellow birch ( <i>Betula alleghensis</i> ), balsam fir ( <i>Abies balsamica</i> ), red spruce ( <i>Picea rubens</i> ), red maple ( <i>Acer rubrum</i> ) <b>Saplings / Shrubs:</b> yellow birch, red maple, black ash ( <i>Fraxinus nigra</i> ) <b>Herbs:</b> wood horsetail ( <i>Equisetum sylvaticum</i> ), sensitive fern ( <i>Onoclea sensibilis</i> ), lady fern ( <i>Athyrium angustum</i> )	A1: Histosol	Surface Water (A1) High Water Table (A2) Saturation (A3) Water Stained Leaves (B9)	P-WL1 within 25-feet of stream; remainder P-WL3	Yes, portions within 25-feet of stream	Contains intermittent stream S02TT. Continues off-site to the south.
W01TTB	PFO/PEM	<b>Trees:</b> red maple, yellow birch <b>Saplings / Shrubs:</b> none <b>Herbs:</b> cottongrass bulrush ( <i>Scirpus cyperinus</i> ), fowl manna grass ( <i>Glyceria striata</i> ), sensitive fern, spotted touch-me-not ( <i>Impatiens capensis</i> ), nodding sedge ( <i>Carex gynandra</i> )	F3: Depleted Matrix	Saturation (A3) Water Stained Leaves (B9)	P-WL2	No	Continues off-site to the south.
W01TTC	PEM	<b>Trees:</b> none <b>Saplings / Shrubs:</b> none <b>Herbs:</b> cottongrass bulrush, fowl manna grass, sensitive fern, spotted touch-me-not, nodding sedge	F3: Depleted Matrix	Saturation (A3) Water Stained Leaves (B9)	P-WL2	No	Continues off-site to the south.
W01TTD	PEM	<b>Trees:</b> none <b>Saplings / Shrubs:</b> none <b>Herbs:</b> cottongrass bulrush, fowl manna grass, sensitive fern, spotted touch-me-not, nodding sedge	F3: Depleted Matrix	Saturation (A3) Water Stained Leaves (B9)	P-WL2	No	Continues off-site to the south.
W01TTE	PFO	<b>Trees:</b> yellow birch, red spruce, balsam fir, red maple <b>Saplings / Shrubs:</b> yellow birch, red maple, black ash <b>Herbs:</b> Woolgrass, fowl manna grass, sensitive fern, spotted touch-me-not, nodding sedge	F3: Depleted Matrix A2: Histic Epipedon	Surface Water (A1) High Water Table (A2) Saturation (A3) Drainage Patters (B10)	P-WL1 within 25-feet of stream; remainder P-WL3	Yes, portions within 25-feet of stream	Contains intermittent streams S02TT and S03TT. Contains previously surveyed VP-D.
W01TTF	PEM/PFO	<b>Trees:</b> yellow birch <b>Saplings / Shrubs:</b> red maple, striped maple ( <i>Acer pennsylvanicum</i> ) <b>Herbs:</b> wood horsetail, lady fern, interrupted fern ( <i>Osmunda claytoniana</i> ), sensitive fern, melic manna grass ( <i>Glyceria melicaria</i> )	F3: Depleted Matrix	Surface Water (A1) High Water Table (A2) Saturation (A3) Drainage Patters (B10) Water Stained Leaves (B9)	P-WL2	No	Receives drainage from gravel road.
W01TTG	PFO	<b>Trees:</b> yellow birch, red maple, balsam fir <b>Saplings / Shrubs:</b> none <b>Herbs:</b> nodding sedge, wood horsetail, sensitive fern, melic manna grass	A2: Histic Epipedon	High Water Table (A2) Saturation (A3)	P-WL3	No	Skidder ruts



WETLAND AND WATERCOURSE DELINEATION AND POTENTIAL VERNAL POOL SURVEY REPORT

Wetland Resource Identifier	Wetland Classification <sup>1</sup>	Dominant Vegetation	Hydric Soil Criteria and Indicator	Evidence of Hydrology	LUPC Wetlands Protection District	Wetland of Special Significance (WoSS/P-WL1)	Additional Comments
W01TTH	PEM	<b>Trees:</b> none <b>Saplings / Shrubs:</b> none <b>Herbs:</b> interrupted fern, nodding sedge, melic manna grass, wood horsetail	A1: Histosol A2: Histic Epipedon	High Water Table (A2) Saturation (A3) Water Stained Leaves (B9)	P-WL2	No	Skidder rut area
W01TTI	PFO	<b>Trees:</b> red maple <b>Saplings / Shrubs:</b> none <b>Herbs:</b> melic manna grass, fowl manna grass, interrupted fern, bristly dewberry ( <i>Rubus hispidus</i> )	A2: Histic Epipedon	Saturation (A3)	P-WL3	No	
W01TTJ	PFO	<b>Trees:</b> red maple <b>Saplings / Shrubs:</b> none <b>Herbs:</b> northeastern manna grass, fowl manna grass, interrupted fern, bristly dewberry	A2: Histic Epipedon	Saturation (A3)	P-WL3	No	
W01TTK	PFO/PEM	<b>Trees:</b> red maple, yellow birch, black ash <b>Saplings / Shrubs:</b> red maple, yellow birch, balsam firm <b>Herbs:</b> sensitive fern, interrupted fern, nodding sedge, fowl manna grass	F3: Depleted Matrix	Saturation (A3) Water Stained Leaves (B9)	P-WL1 within 25-feet of stream; remainder P-WL2	Yes, portions within 25-feet of stream	Ephemeral stream S04TT flows from wetland. Contains previously surveyed VP-F.
W01TTY	PFO	<b>Trees:</b> balsam fir, eastern arbovitae ( <i>Thuja occidentalis</i> ), red spruce <b>Saplings / Shrubs:</b> balsam fir, northern white cedar, red maple, eastern hemlock ( <i>Tsuga canadensis</i> ), yellow birch <b>Herbs:</b> sensitive fern, bristly dewberry, melic manna grass, nodding sedge, interrupted fern, wood horsetail, crested woodfern ( <i>Dryopteris cristata</i> )	F3: Depleted Matrix,	High Water Table (A2) Saturation (A3) Water Stained Leaves (B9)	P-WL3	No	Receives drainage from gravel road.
W01TTZ	PFO	<b>Trees:</b> balsam fir, red maple <b>Saplings / Shrubs:</b> none <b>Herbs:</b> interrupted fern, melic manna grass, nodding sedge, sensitive fern	A2: Histic Epipedon	Surface Water (A1) High Water Table (A2) Saturation (A3)	P-WL3	No	Receives drainage from gravel road.
W02TTA	PFO/PEM	<b>Trees:</b> balsam fir, red maple <b>Saplings / Shrubs:</b> none <b>Herbs:</b> interrupted fern, melic manna grass, nodding sedge, sensitive fern	A2: Histic Epipedon	Surface Water (A1) High Water Table (A2) Saturation (A3)	P-WL2	No	Skidder rut and receives drainage from gravel road.
W02TTB	PFO	<b>Trees:</b> balsam fir, red maple, yellow birch <b>Saplings / Shrubs:</b> speckled alder ( <i>Alnus incana</i> ), pussy willow ( <i>Salix discolor</i> ) <b>Herbs:</b> interrupted fern, melic manna grass, nodding sedge, sensitive fern	A2: Histic Epipedon	Surface Water (A1) High Water Table (A2) Saturation (A3)	P-WL1 within 25-feet of stream; remainder P-WL3	Yes, portions within 25-feet of stream	Contains stream S12TT.



WETLAND AND WATERCOURSE DELINEATION AND POTENTIAL VERNAL POOL SURVEY REPORT

Wetland Resource Identifier	Wetland Classification <sup>1</sup>	Dominant Vegetation	Hydric Soil Criteria and Indicator	Evidence of Hydrology	LUPC Wetlands Protection District	Wetland of Special Significance (WoSS/P-WL1)	Additional Comments
W02TTC	PFO	<b>Trees:</b> red maple, balsam fir <b>Saplings / Shrubs:</b> witch hazel ( <i>Hamamelis virginiana</i> ) <b>Herbs:</b> interrupted fern, sensitive fern, cinnamon fern	A2: Histic Epipedon,	Saturation (A3)	P-WL3	No	Continues off-site to the north.
W02TTD	PEM	<b>Trees:</b> none <b>Saplings / Shrubs:</b> none <b>Herbs:</b> nodding sedge, interrupted fern, wood horsetail	F3: Depleted Matrix	Surface Water (A1) High Water Table (A2) Saturation (A3)	P-WL2	No	Disturbed roadside depression. Contains previously surveyed VP-A.
W02TTE	PFO/PEM	<b>Trees:</b> red maple, balsam fir <b>Saplings / Shrubs:</b> witch hazel <b>Herbs:</b> interrupted fern, sensitive fern, cinnamon fern	A2: Histic Epipedon,	Surface Water (A1) High Water Table (A2) Saturation (A3)	P-WL2	No	Continues off-site to the northeast.
W02TTG	PEM	<b>Trees:</b> none <b>Saplings / Shrubs:</b> none <b>Herbs:</b> sensitive fern, nodding sedge, wrinkle-leaf goldenrod ( <i>Solidago rugosa</i> ), lady fern, interrupted fern, wood horsetail	A2: Histic Epipedon	Saturation (A3)	P-WL2	No	
W02TTH	PEM	<b>Trees:</b> red spruce, yellow birch, hemlock, balsam fir, hemlock <b>Saplings / Shrubs:</b> yellow birch, red maple, red spruce <b>Herbs:</b> interrupted fern, nodding sedge, cottongrass bulrush, sensitive fern	F3: Depleted Matrix	Surface Water (A1) High Water Table (A2) Saturation (A3)	P-WL2	No	Small skid trail
W02TTI	PSS	<b>Trees:</b> none <b>Saplings / Shrubs:</b> red maple, speckled alder <b>Herbs:</b> sensitive fern, wrinkle-leaf goldenrod, interrupted fern, nodding sedge	F3: Depleted Matrix	Saturation (A3) Water Stained Leaves (B9)	P-WL2	No	Small roadside excavation
W02TTJ	PFO	<b>Trees:</b> red spruce, yellow birch, hemlock, balsam fir <b>Saplings / Shrubs:</b> yellow birch, red spruce, red maple <b>Herbs:</b> interrupted fern, evergreen wood fern	A12: Thick Dark Surface	Surface Water (A1) Saturation (A3) Drainage Patterns (B10)	P-WL3	No	
W02TTK	PFO	<b>Trees:</b> red maple, yellow birch, eastern arborvitae, red spruce, balsam fir <b>Saplings / Shrubs:</b> red maple, speckled alder, yellow birch, balsam fir, eastern arborvitae <b>Herbs:</b> nodding sedge, melic manna grass, fowl manna grass, spotted touch-me-not, cottongrass bulrush, sensitive fern, interrupted fern	F3: Depleted Matrix A2: Histic Epipedon	Surface Water (A1)	P-WL1 within 25-feet of stream; remainder P-WL3	Yes, portions within 25-feet of streams	Contains multiple intermittent and perennial streams. Contains previously surveyed VP-G. Extends off-site to the southeast.



WETLAND AND WATERCOURSE DELINEATION AND POTENTIAL VERNAL POOL SURVEY REPORT

Wetland Resource Identifier	Wetland Classification <sup>1</sup>	Dominant Vegetation	Hydric Soil Criteria and Indicator	Evidence of Hydrology	LUPC Wetlands Protection District	Wetland of Special Significance (WoSS/P-WL1)	Additional Comments
W02TTL	PEM	<b>Trees:</b> balsam fir, white ash ( <i>Fraxinus americana</i> ), American beech, red maple <b>Saplings / Shrubs:</b> beaked hazel ( <i>Corylus cornuta</i> ) <b>Herbs:</b> interrupted fern, spotted touch-me-not, northeastern manna grass, wood horsetail	F3: Depleted Matrix	Surface Water (A1) High Water Table (A2) Saturation (A3) Water Stained Leaves (B9)	P-WL2	No	
W02TTM	PFO	<b>Trees:</b> sugar maple ( <i>Acer saccharum</i> ), balsam fir, red maple, yellow birch <b>Saplings / Shrubs:</b> striped maple, red maple, yellow birch, witch hazel <b>Herbs:</b> three-seed sedge ( <i>Carex trisperma</i> ), false lily-of-the-valley ( <i>Maianthemum canadense</i> ), interrupted fern, wood horsetail	F3: Depleted Matrix	Surface Water (A1) High Water Table (A2) Saturation (A3) Geomorphic position (D2)	P-WL3	No	
W02TTN	PEM	<b>Trees:</b> none <b>Saplings / Shrubs:</b> none <b>Herbs:</b> necklace sedge ( <i>Carex projecta</i> ), spotted touch-me-not, melic manna grass, sensitive fern	F3: Depleted Matrix	High Water Table (A2) Saturation (A3) Water Stained Leaves (B9)	P-WL2	No	
W01LPA	PFO/PEM	<b>Trees:</b> balsam fir, red maple, eastern arborvitae <b>Saplings / Shrubs:</b> yellow birch, red spruce <b>Herbs:</b> interrupted fern, wood horsetail, sensitive fern, cinnamon fern	A2: Histic Epipedon	Surface Water (A1) High Water Table (A2) Saturation (A3) Water Stained Leaves (B9)	P-WL1 within 25-feet of stream; remainder P-WL2	Yes, portions within 25-feet of stream	Large, forested wetland with multiple skidder rut crossings and disturbances. Stream S11TT flows from the wetland. Contains PVPs 03TT and 01LP.
W01LPB	PFO	<b>Trees:</b> red spruce, yellow birch, hemlock, balsam fir <b>Saplings / Shrubs:</b> yellow birch, red spruce, red maple <b>Herbs:</b> interrupted fern, evergreen wood fern	A12: Thick Dark Surface	Surface Water (A1) Saturation (A3) Drainage Patterns (B10)	P-WL3	No	
W01LPC	PFO	<b>Trees:</b> red spruce, yellow birch, hemlock, balsam fir <b>Saplings / Shrubs:</b> yellow birch, red spruce <b>Herbs:</b> interrupted fern, red maple	F3: Depleted Matrix	Surface Water (A1) High Water Table (A2) Saturation (A3) Drainage Patterns (B10)	P-WL3	No	Extends off-site to the southeast.

<sup>1</sup> Wetland classification follows Federal Geographic Data Committee. (2013):

- PFO = Palustrine Forested
- PEM = Palustrine Emergent
- PSS = Palustrine Scrub-Shrub
- PUB = Palustrine Unconsolidated Bottom



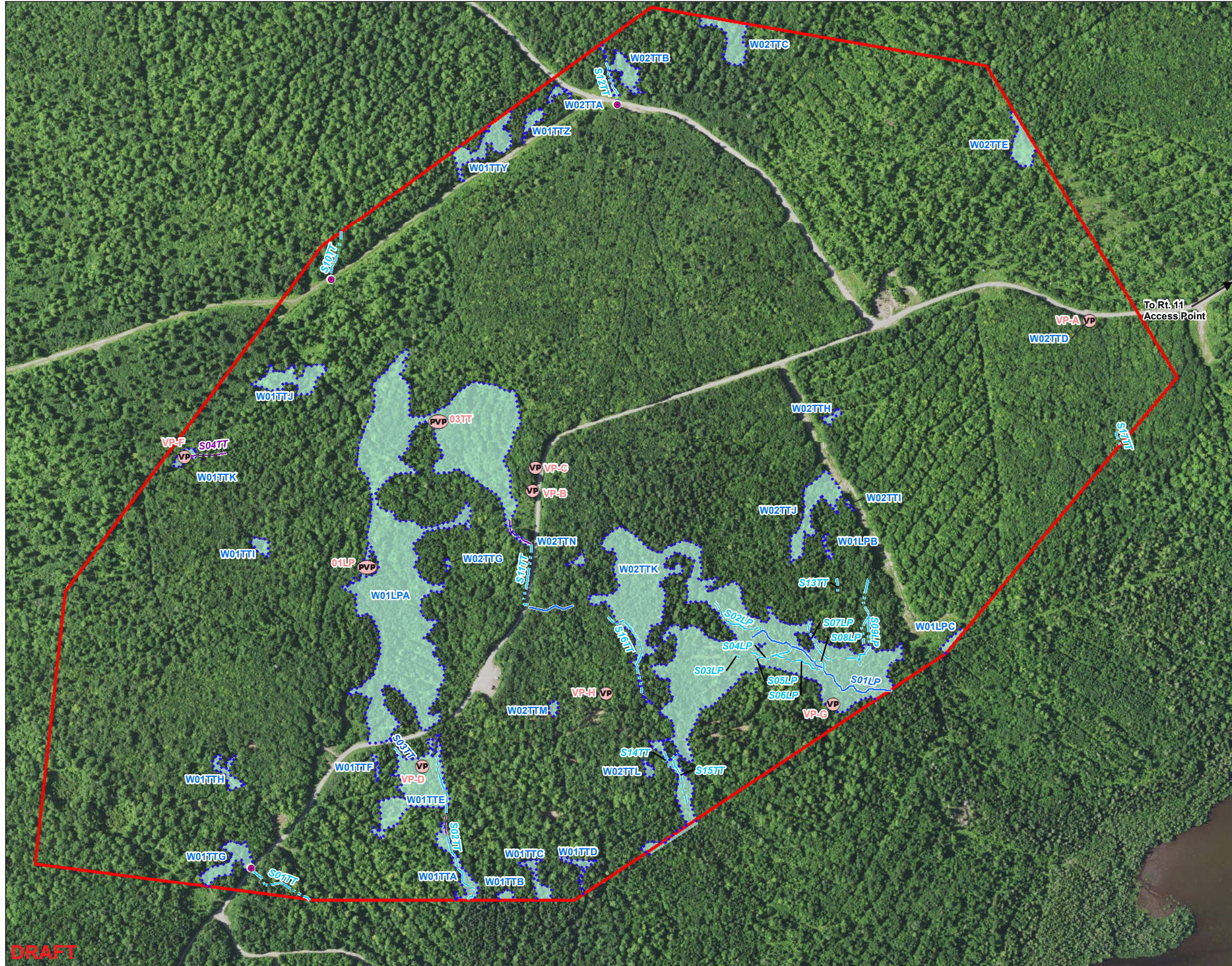
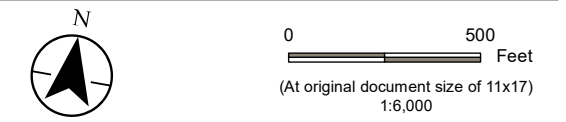

Figure No. **1**  
 Title **Delineated Wetlands and Streams Map**

Client/Project  
 Wolfden Resources Corporation  
 Pickett Mountain Metallic Mine Project

Project Location 195602317  
 T6 R6 WELS, Maine Prepared by MM on 2023-03-06  
 TR by TT on 2023-03-06  
 IR Review by BB on 2023-03-06



- Potential Vernal Pool
- Vernal Pool (Identified by Others)
- Culvert
- Delineated Perennial Stream
- - - Delineated Intermittent Stream
- · · Delineated Ephemeral Stream
- ▭ Delineated Wetland
- ▭ Approximate Survey Limits



- Notes**
1. Wetland boundaries and other features were located utilizing an EOS Arrow 100 GNSS GPS Receiver. The estimated average accuracy of GPS data is within 1-2 meters of the actual position.
  2. Wetland boundaries delineated in accordance with the USACE Wetland Delineation Manual and the Regional Supplement to the Corps of Engineers Wetland Delineation Manual: Northcentral and Northeast Regional Supplement (Version 2.0).
  3. Coordinate System: NAD 1983 StatePlane Maine East FIPS 1801 Feet
  4. Data Source: Wolfden
  5. Background: Maine NAIP 2018.



**DRAFT**

C:\Users\carolm\OneDrive\Documents\2023\17\_01\_PickettMnt\_WetlandDeline.mxd Revised: 2023-03-06 By: nrmason

Disclaimer: Stantec assumes no responsibility for data supplied in electronic format. The recipient accepts full responsibility for verifying the accuracy and completeness of the data. The recipient releases Stantec, its officers, employees, consultants and agents, from any and all claims arising in any way from the content or provision of the data.