

ALIGNMENT "DIPPER POND" - ROAD
(0+00 TO 26+00)

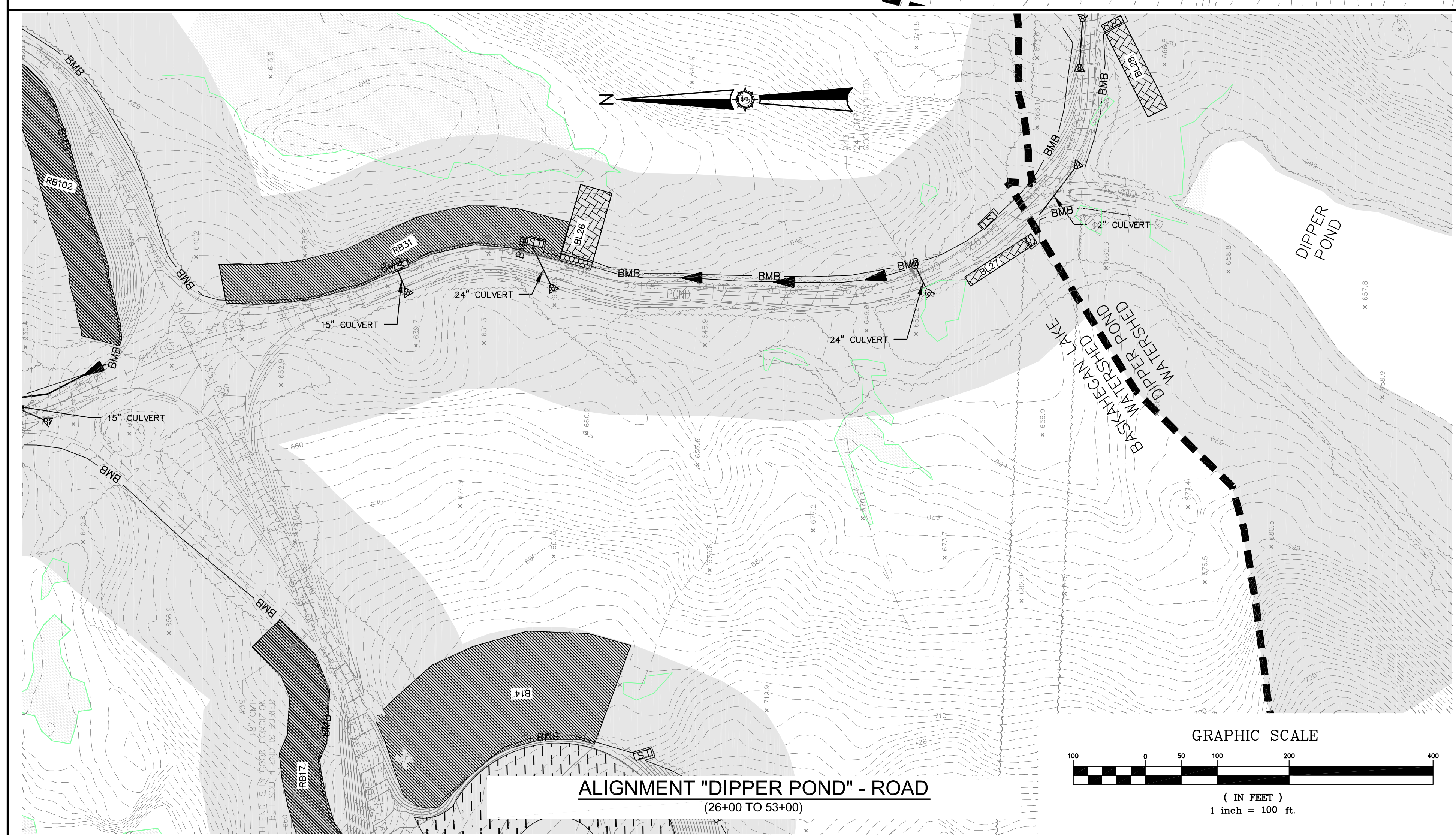

ALIGNMENT "DIPPER POND" - ROAD
(26+00 TO 53+00)

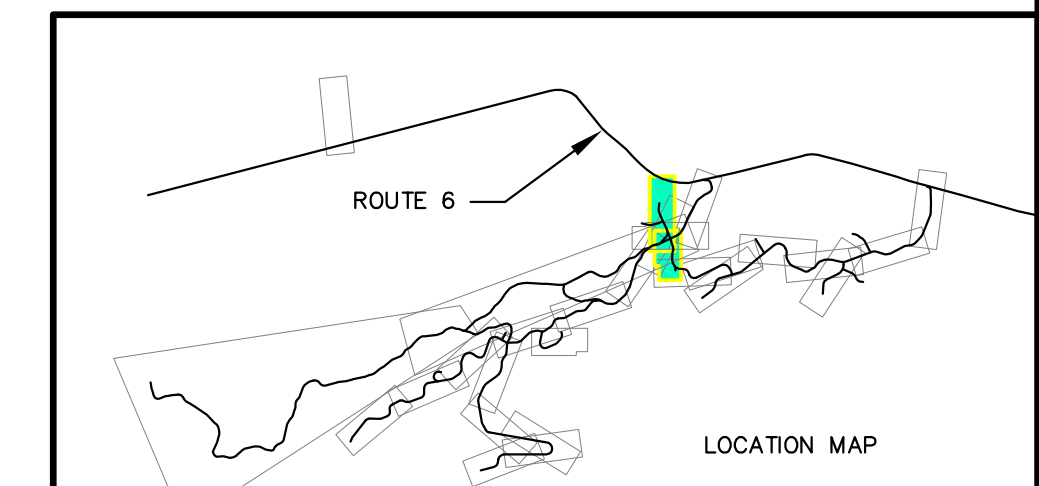
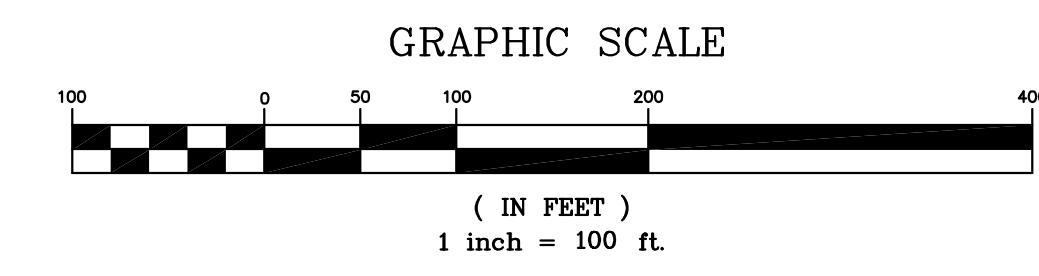
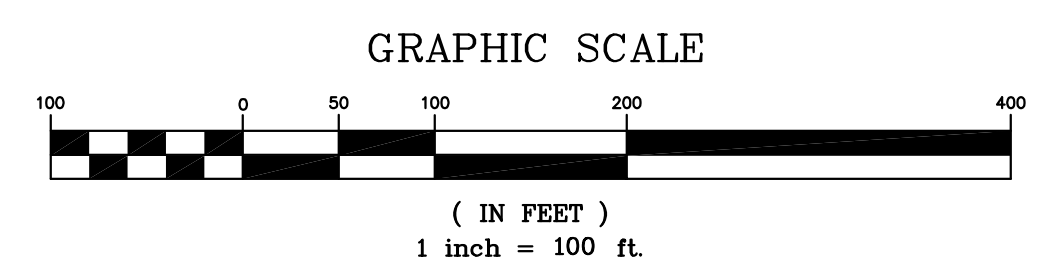

PRELIMINARY NOT FOR CONSTRUCTION

Drawn By	JAO
Checked By	DATE
Designated By	DATE
Issued For Agency Review	DATE
Drawn By	JAO
Checked By	DATE
Designated By	DATE
Issued For Agency Review	DATE

BOWERS WIND PROJECT	
Project Location	CARROLL PLANTATION & KOSSUTH TOWNSHIP, MAINE
University Organization	GEORGETOWN COLLEGE
Scale	1"=100'
Approval	Checked
DIPPER POND ROAD EROSION CONTROL PLAN	

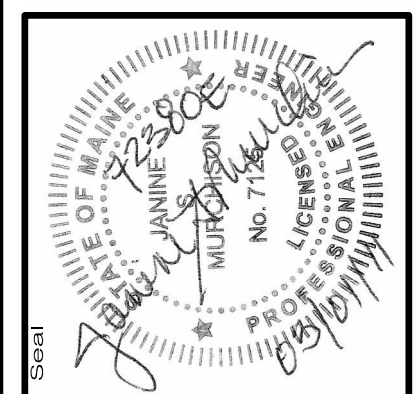

Project No. **72380E**

AN INTEGRATED TEAM OF
SEWALL
 GEOSPATIAL ENGINEERING
 SURVEYING AND NATURAL
 RESOURCE CONSULTANTS
 JAMES W. SEWALL COMPANY Since 1880
 SEWALLCOM 800.648.4202



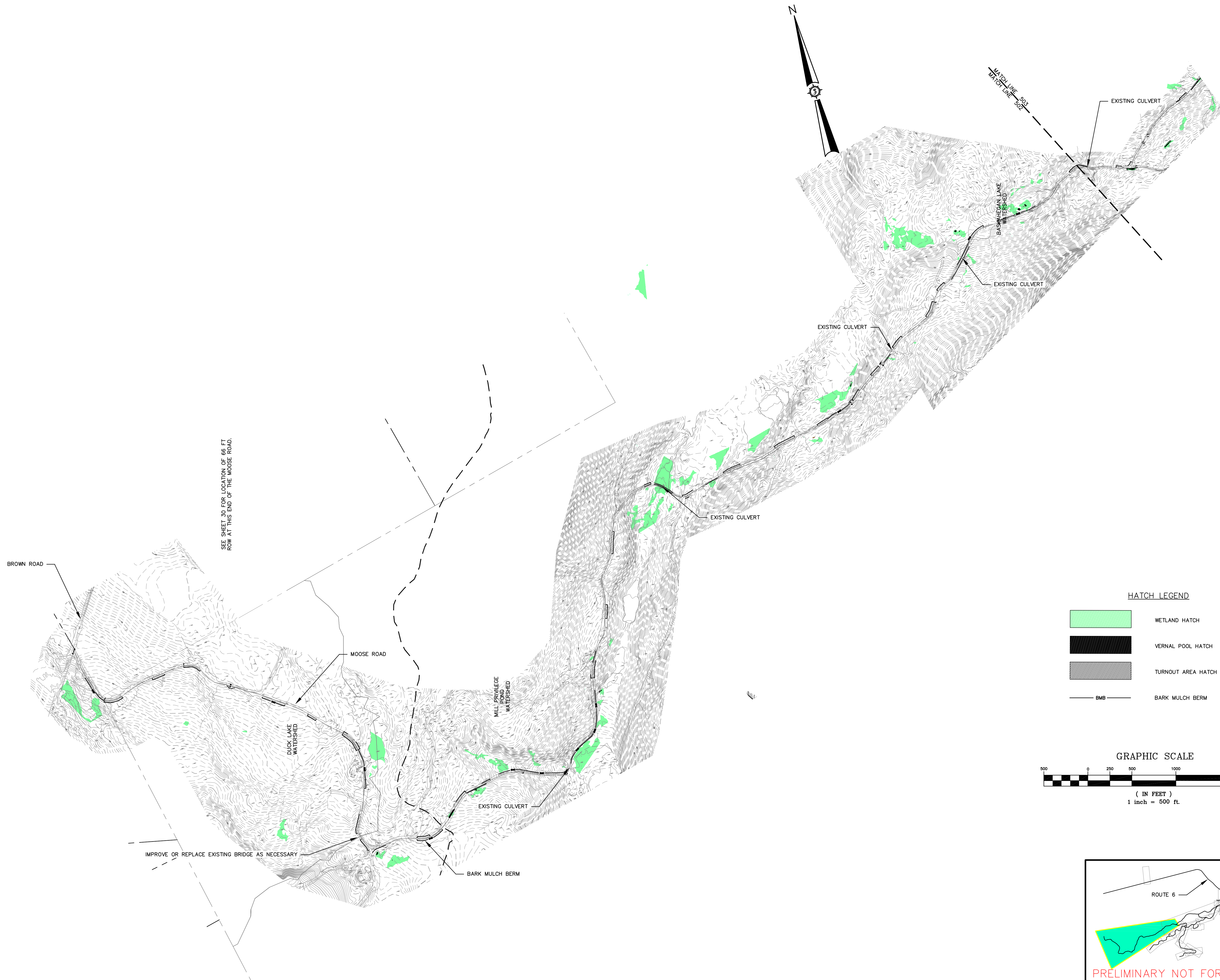

Permit No. **PERMIT**

Sheet No. **500**

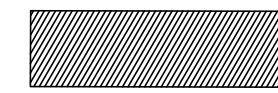

SEE SHEET 30 FOR LOCATION OF 66 FT ROW AT THIS END OF THE MOOSE ROAD.

HATCH LEGEND

-  WETLAND HATCH
-  VERNAL POOL HATCH
-  TURNOUT AREA HATCH
-  BMB BARK MULCH BERM

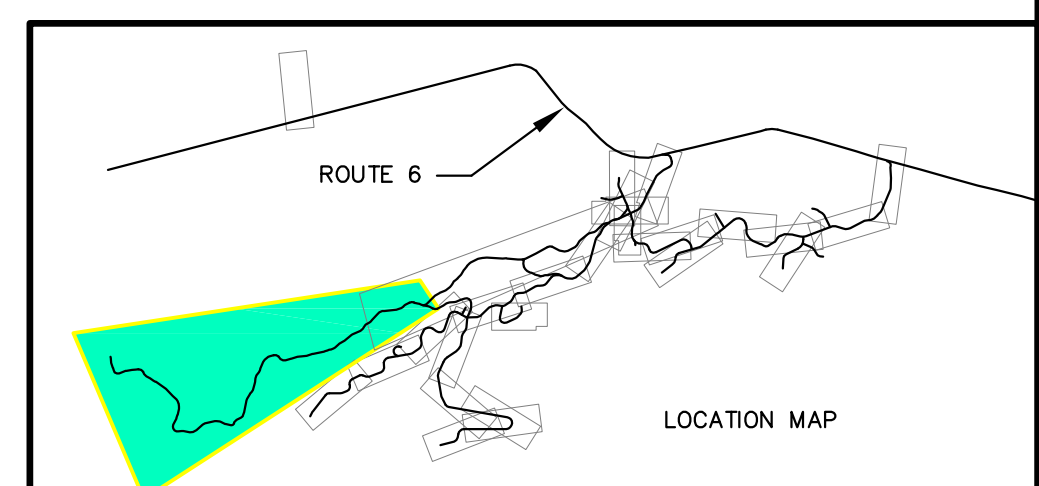
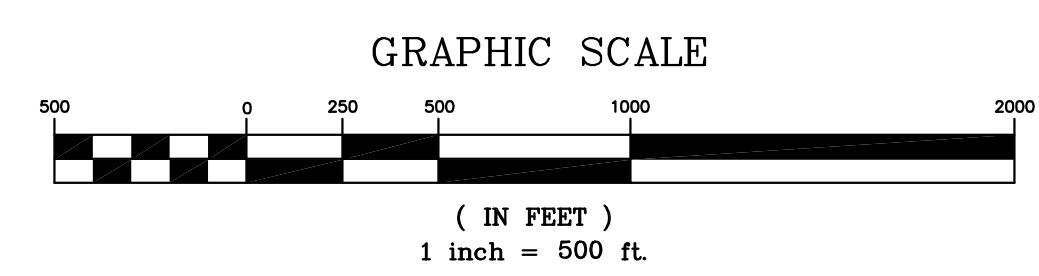

PRELIMINARY NOT FOR CONSTRUCTION

Drawn By	M/T	Date	3/17/2011
Checked By			
Issue #	A	Issued For	AGENCY REVIEW

Designed By	JSM	Drawn By	M/T
Scale	MARCH 2011	Checked By	
Scale	1"=500'	Approved	
Project Location CARROLL PLANTATION & KOSSUTH TOWNSHIP, MAINE			
Drawing Description MOOSE ROAD ACCESS ROAD			

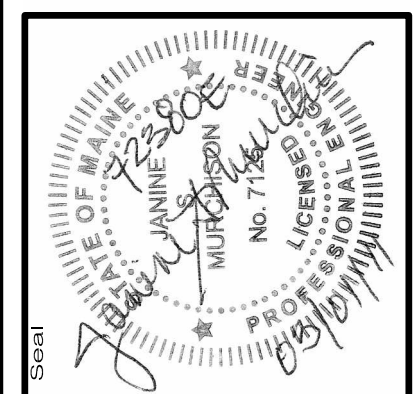

72380E

AN INTEGRATED TEAM OF
SEWALL
 GEOSPATIAL ENGINEERING,
 SURVEYING AND NATURAL
 RESOURCE CONSULTANTS

JAMES W. SEWALL COMPANY Since 1880
 SEWALL.COM 800.648.4202

PERMIT

Sheet No. **502**

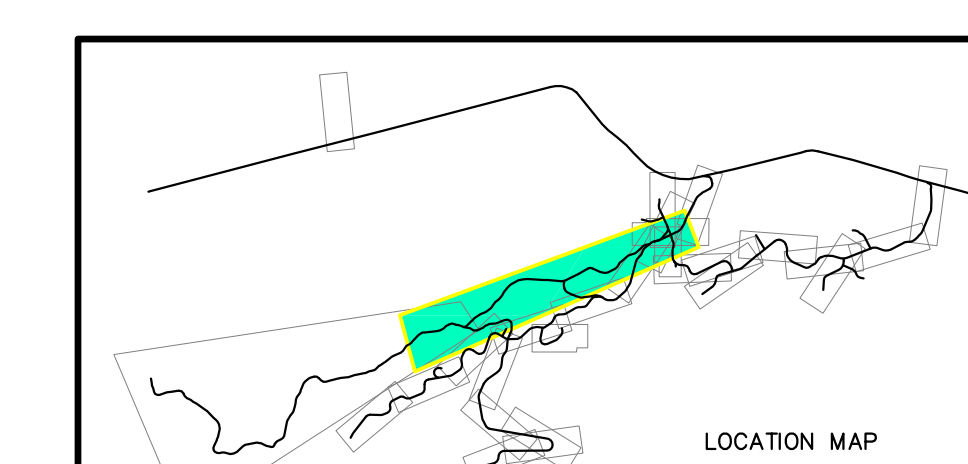
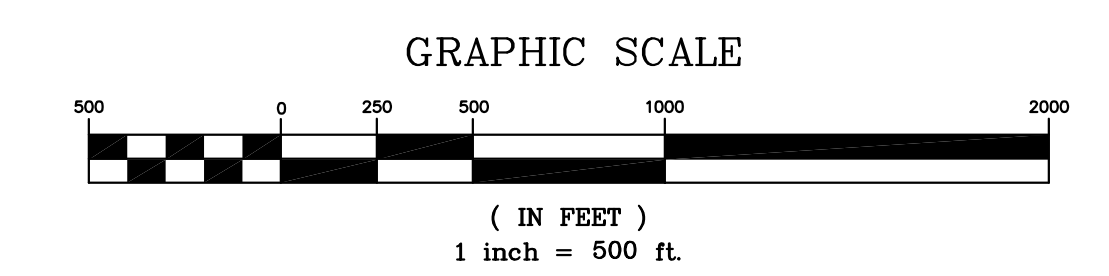
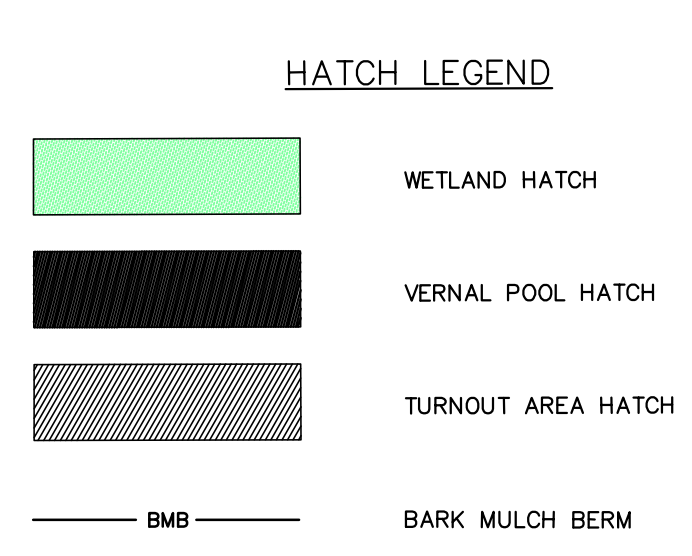
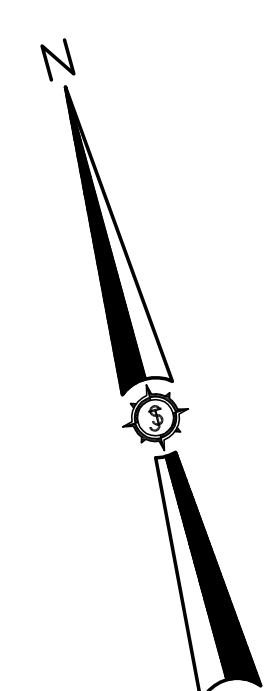
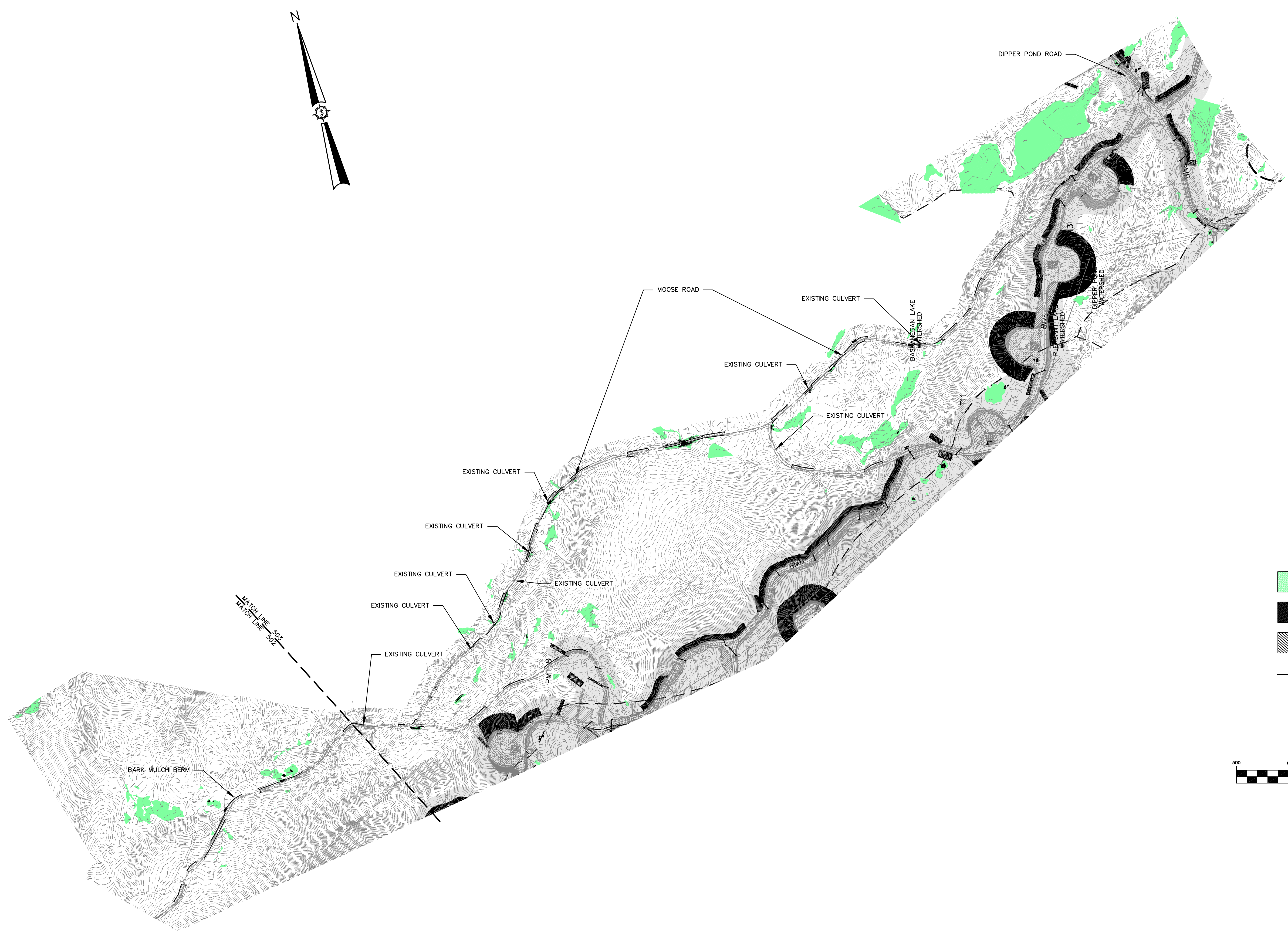

PRELIMINARY NOT FOR CONSTRUCTION

Drawn By	JSM	Checked	
Designated By	JSM	Approved	
Issue #	A	Issued For Agency Review	
Date	3/1/2011		

BOWERS WIND PROJECT	
Project Location	CARROLL PLANTATION & KOSSUTH TOWNSHIP, MAINE
Drawing Description	MOOSE ROAD ACCESS ROAD
Scale	1" = 500'
Drawn By	JSM
Designated By	JSM
Checked	
Approved	

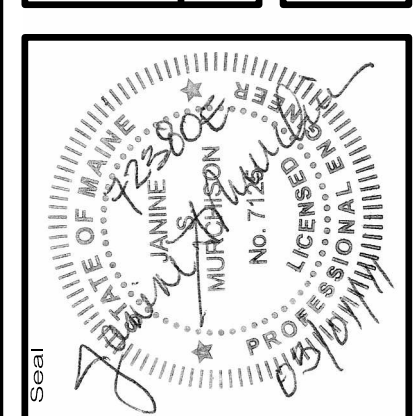

72380E

AN INTEGRATED TEAM OF
GEOSPATIAL ENGINEERING,
SURVEYING AND NATURAL
RESOURCE CONSULTANTS

SEWALL
JAMES W. SEWALL COMPANY Since 1880
SEWALL.COM 800.648.4202

Project No. 72380E
Phase: **PERMIT**

Sheet No. **503**

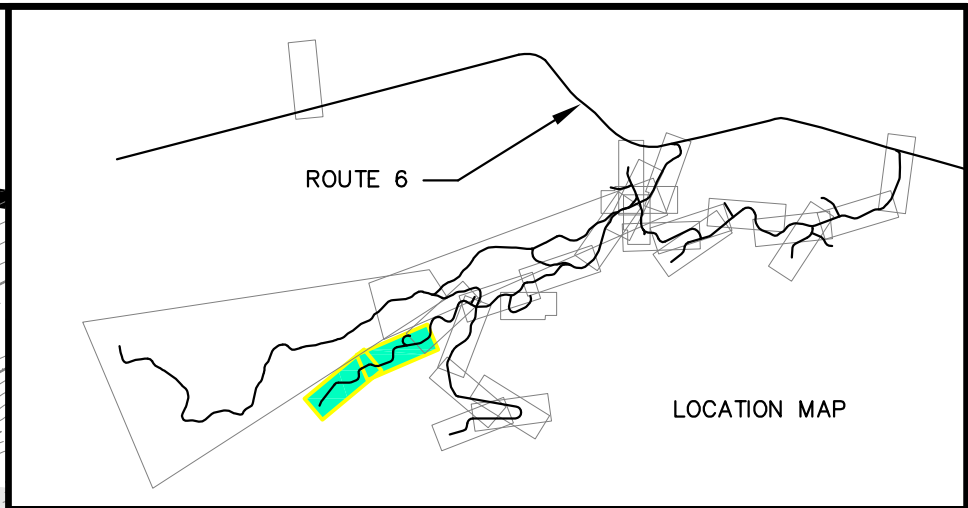
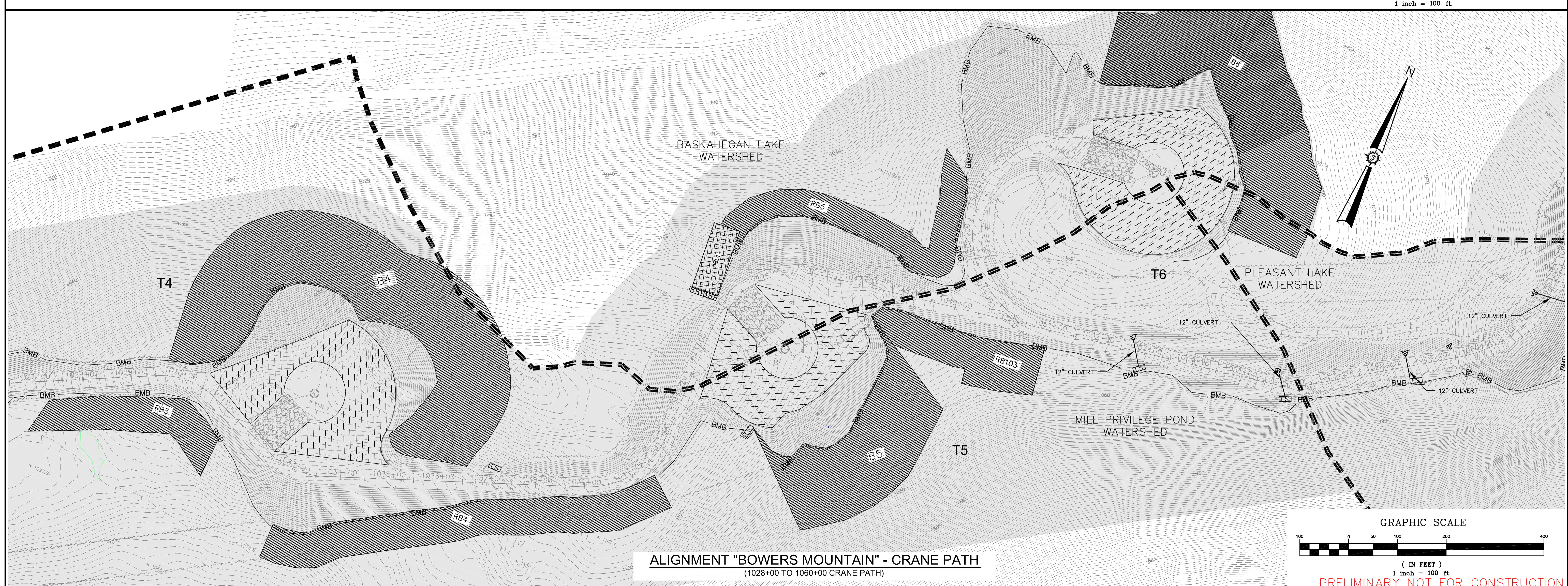
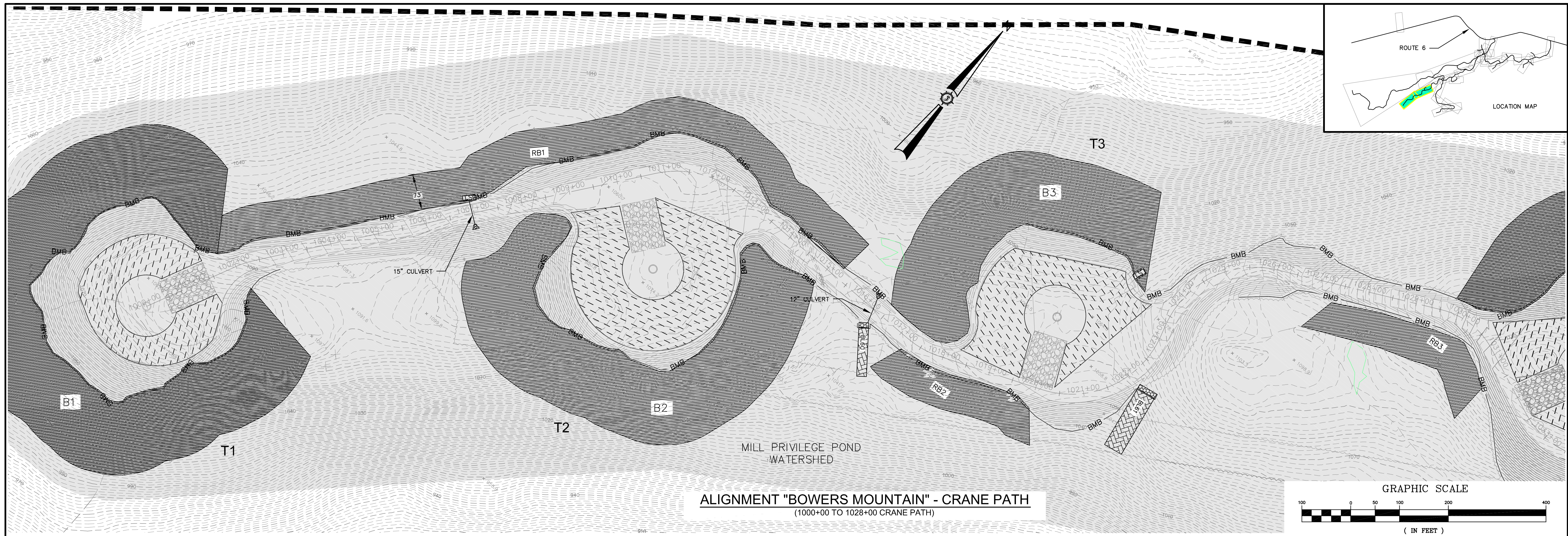

Drawn By:	JAO
Checked By:	JSM
Issue Date:	3/17/2011
Revision:	
Scale:	1"=100'
Project Location:	CARROLL PLANTATION & KOSSUTH TOWNSHIP, MAINE
Project Name:	BOWERS MOUNTAIN
Project No.:	72380E
Sheet No.:	600

BOWERS WIND PROJECT

Project Location: CARROLL PLANTATION & KOSSUTH TOWNSHIP, MAINE

Project Name: BOWERS MOUNTAIN

Project No.: 72380E

Sheet No.: 600

Scale: 1"=100'

Drawn By: JAO

Checked By: JSM

Issue Date: 3/17/2011

Revision:

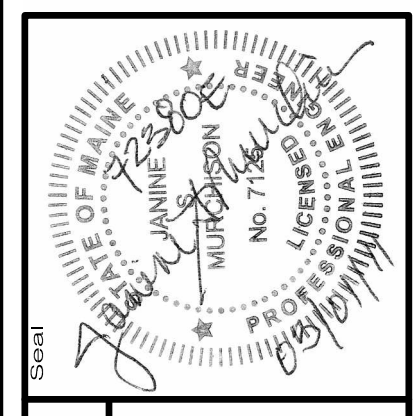

72380E

AN INTEGRATED TEAM OF
GEOSPATIAL ENGINEERING,
SURVEYING AND NATURAL
RESOURCE CONSULTANTS

SEWALL
JAMES W. SEWALL COMPANY Since 1880
SEWALLCOM 800.648.4202

PERMIT

600

PRELIMINARY NOT FOR CONSTRUCTION

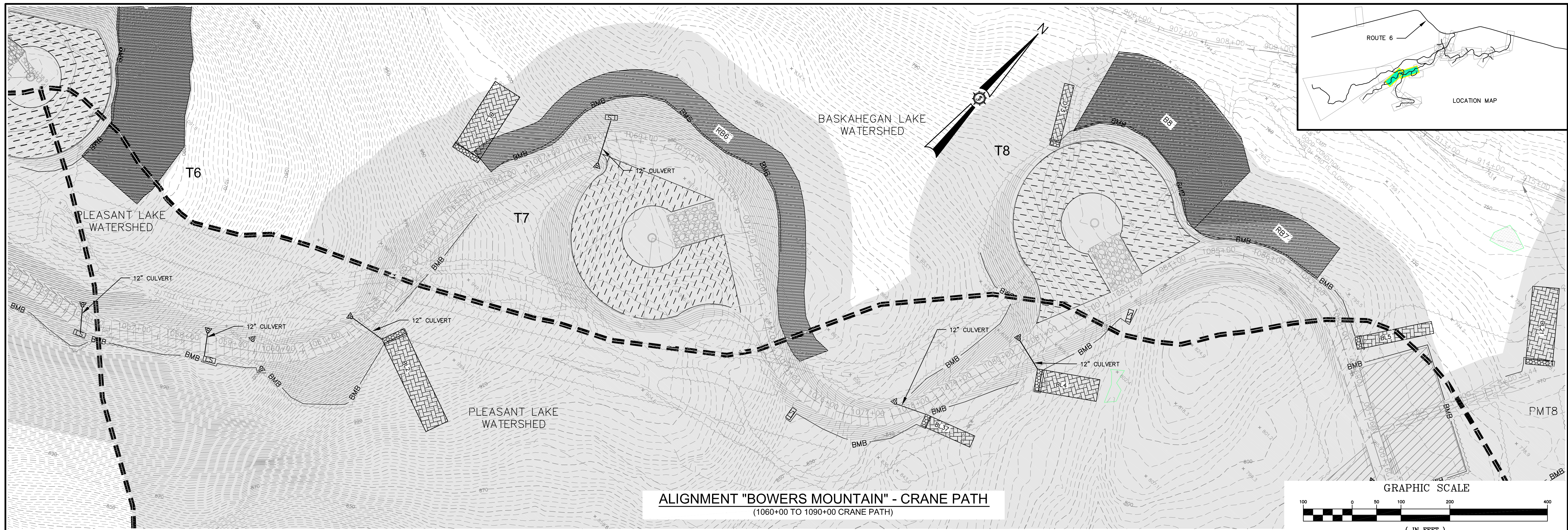

ALIGNMENT "BOWERS MOUNTAIN" - CRANE PATH
(1060+00 TO 1090+00 CRANE PATH)

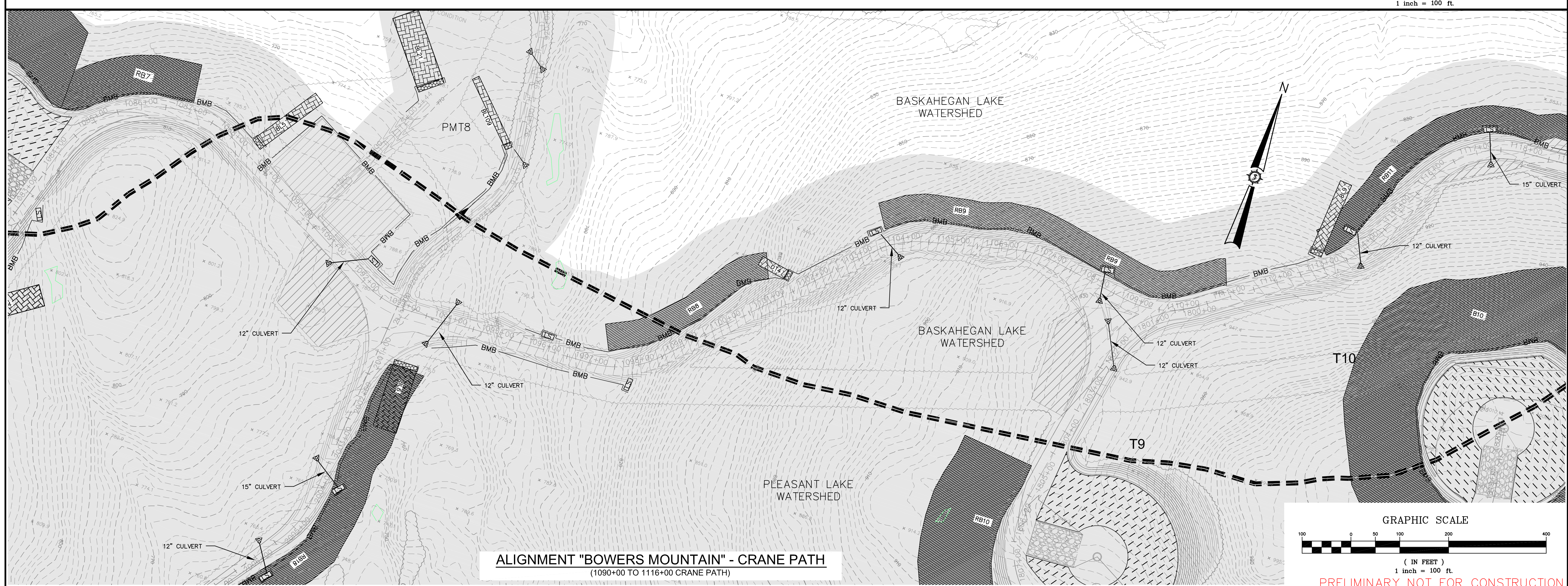
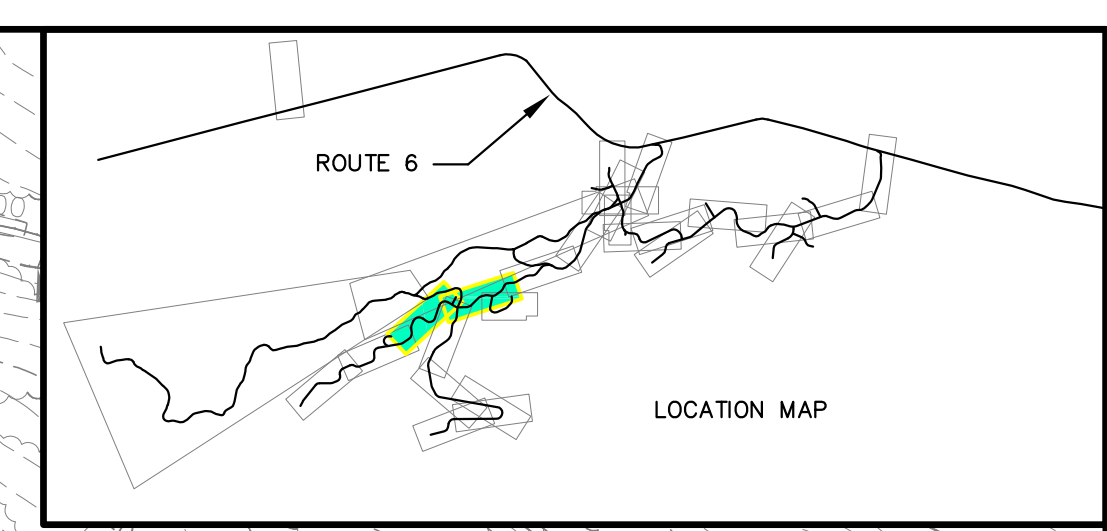
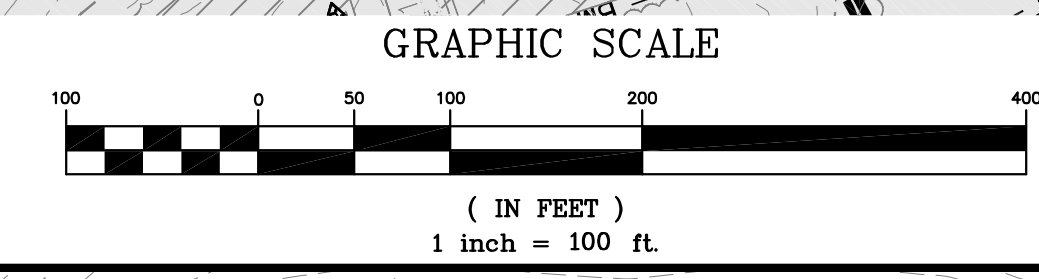

ALIGNMENT "BOWERS MOUNTAIN" - CRANE PATH
(1090+00 TO 1116+00 CRANE PATH)

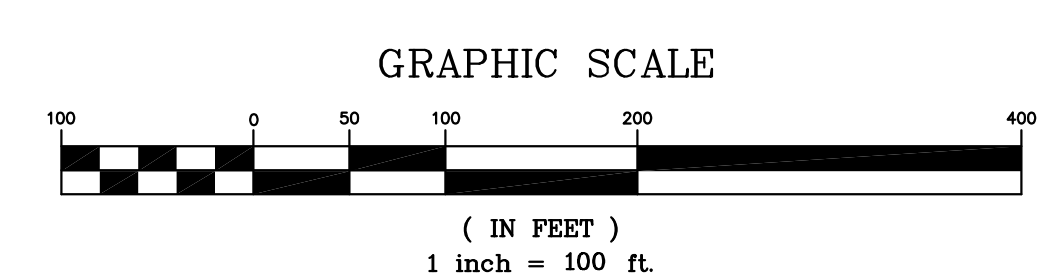

PRELIMINARY NOT FOR CONSTRUCTION

Drawn By	JSM
Checked By	
Issue Date	3/7/2011
Revision	
Issued For Agency Review	
Drawn By	
Checked By	
Issue Date	
Revision	
Issued For Agency Review	

BOWERS WIND PROJECT	
Drawn By	JAO
Checked By	
Issue Date	MARCH 2011
Revision	
Issued For Agency Review	
Drawn By	
Checked By	
Issue Date	
Revision	
Issued For Agency Review	

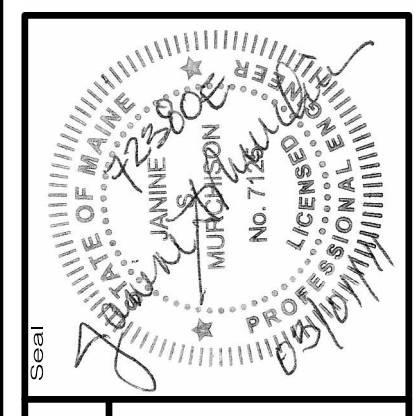

72380E

AN INTEGRATED TEAM OF
 GEOSPATIAL ENGINEERING,
 SURVEYING AND NATURAL
 RESOURCE CONSULTANTS

SEWALL
 JAMES W. SEWALL COMPANY Since 1880
 SEWALLCOM 800.648.4202

Project No. 72380E

Phase **PERMIT**

Sheet No. **601**

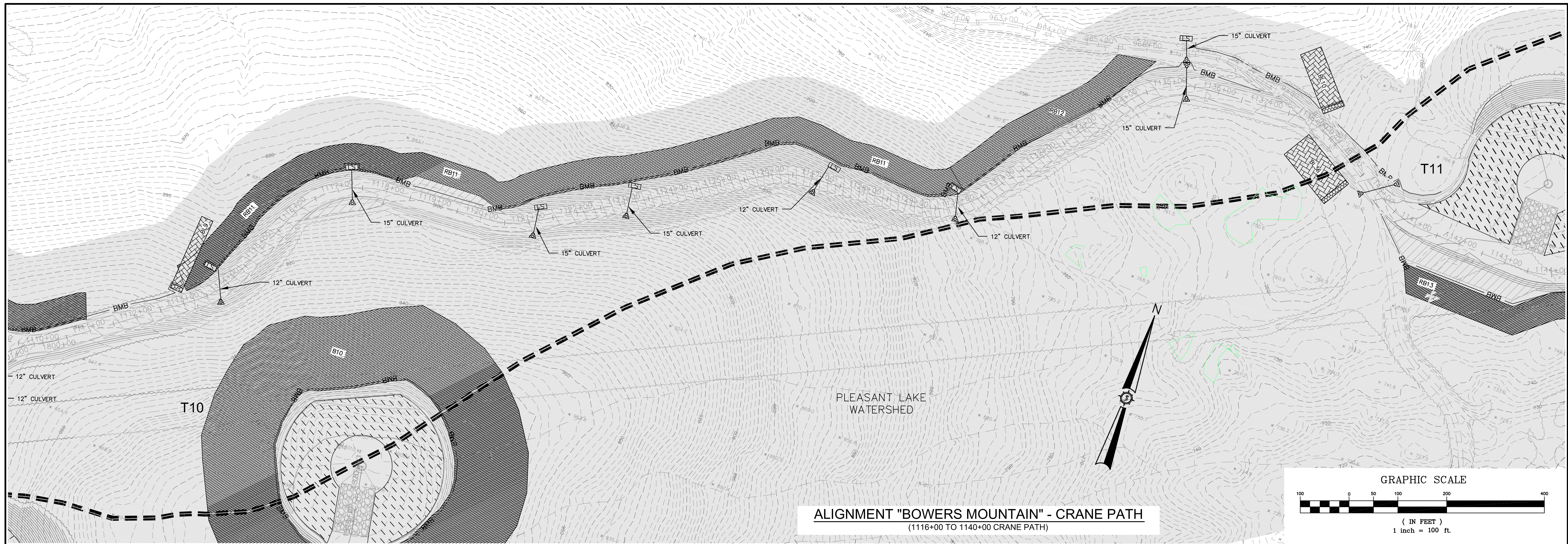

ALIGNMENT "BOWERS MOUNTAIN" - CRANE PATH
(1116+00 TO 1140+00 CRANE PATH)

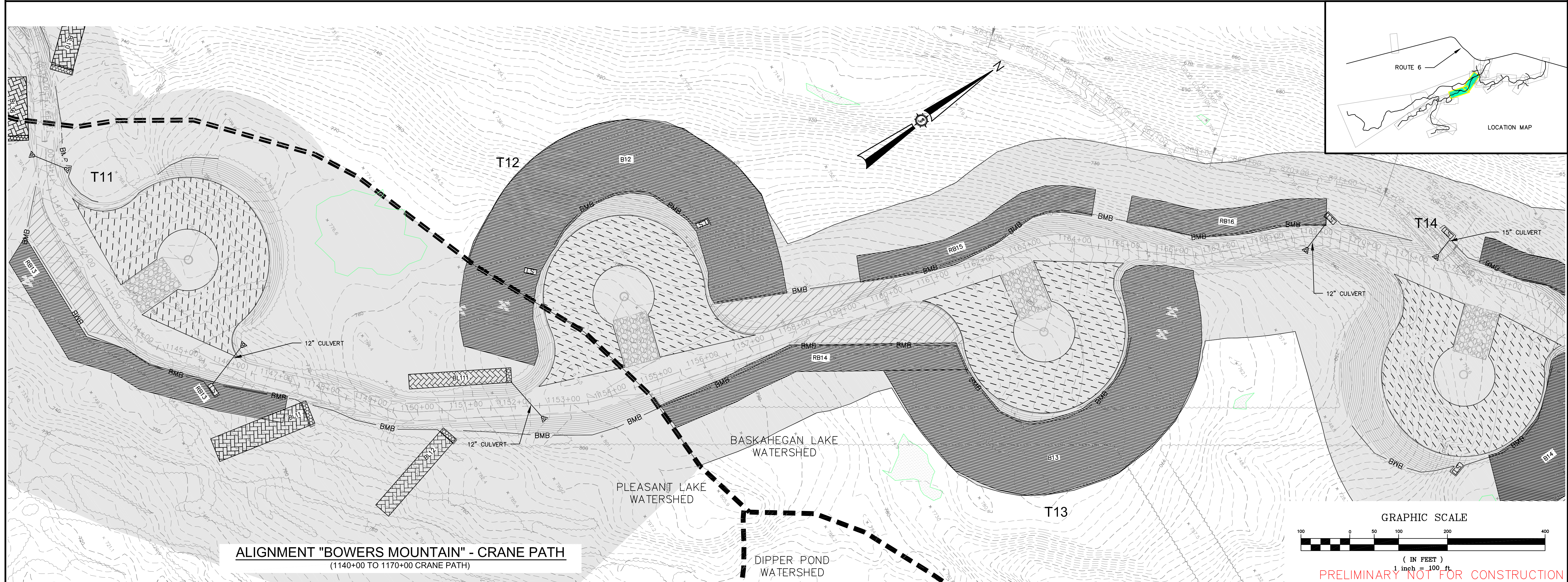
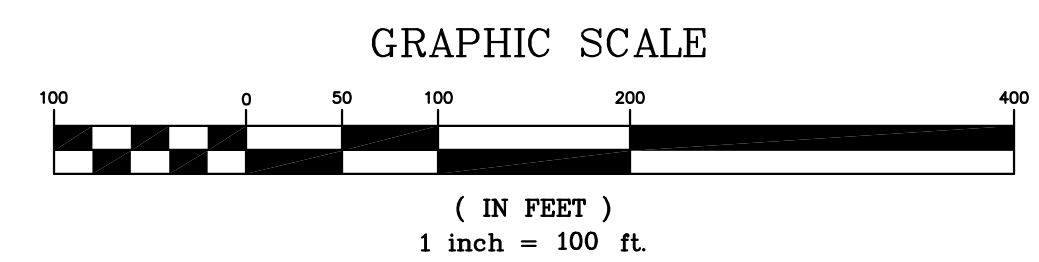

ALIGNMENT "BOWERS MOUNTAIN" - CRANE PATH
(1140+00 TO 1170+00 CRANE PATH)

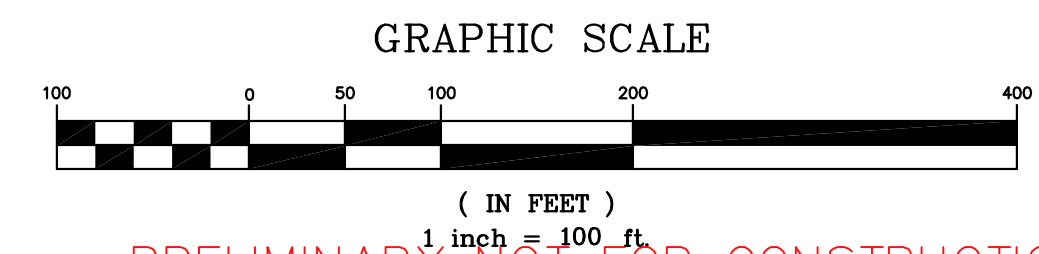

PRELIMINARY NOT FOR CONSTRUCTION

Drawn By	JSM	Date	3/17/2011
Checked By			
Reviewed By			
Issued For Agency Review			

Developed By	JAO	Drawn By	JSM
Checked By		Reviewed By	
Date	MARCH 2011	Scale	1"=100'
Project Location	CARROLL PLANTATION & KOSSUTH TOWNSHIP, MAINE		
Drawing Description	BOWERS MOUNTAIN EROSION CONTROL PLAN		

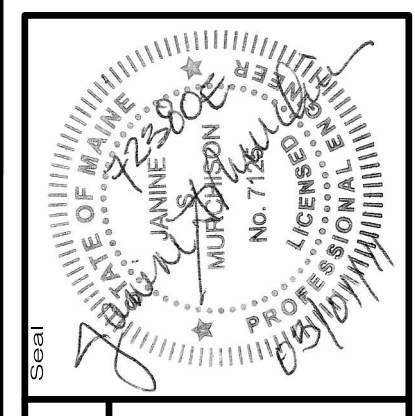

72380E

AN INTEGRATED TEAM OF
SEWALL
 GEOSPATIAL ENGINEERING
 SURVEYING AND NATURAL
 RESOURCE CONSULTANTS
 JAMES W. SEWALL COMPANY Since 1880
 SEWALLOM 800.648.4202

Project No. 72380E

Permit

Sheet No. **602**

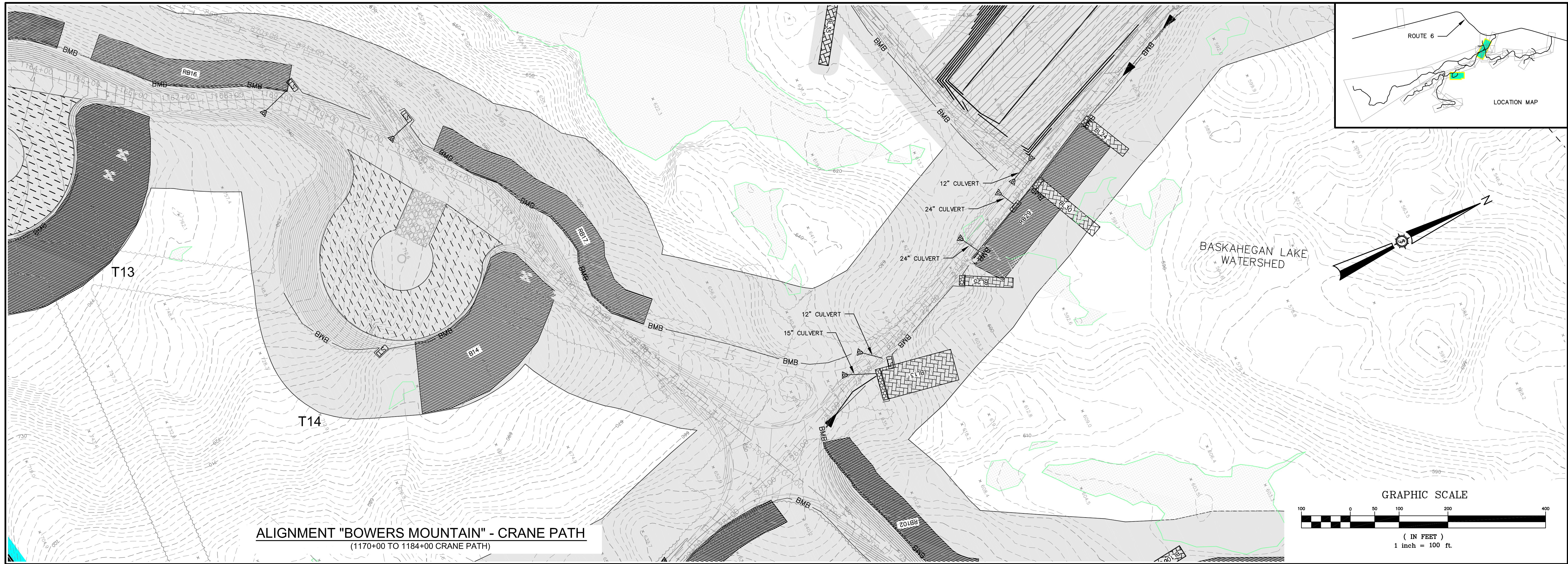

ALIGNMENT "BOWERS MOUNTAIN" - CRANE PATH
 (1170+00 TO 1184+00 CRANE PATH)

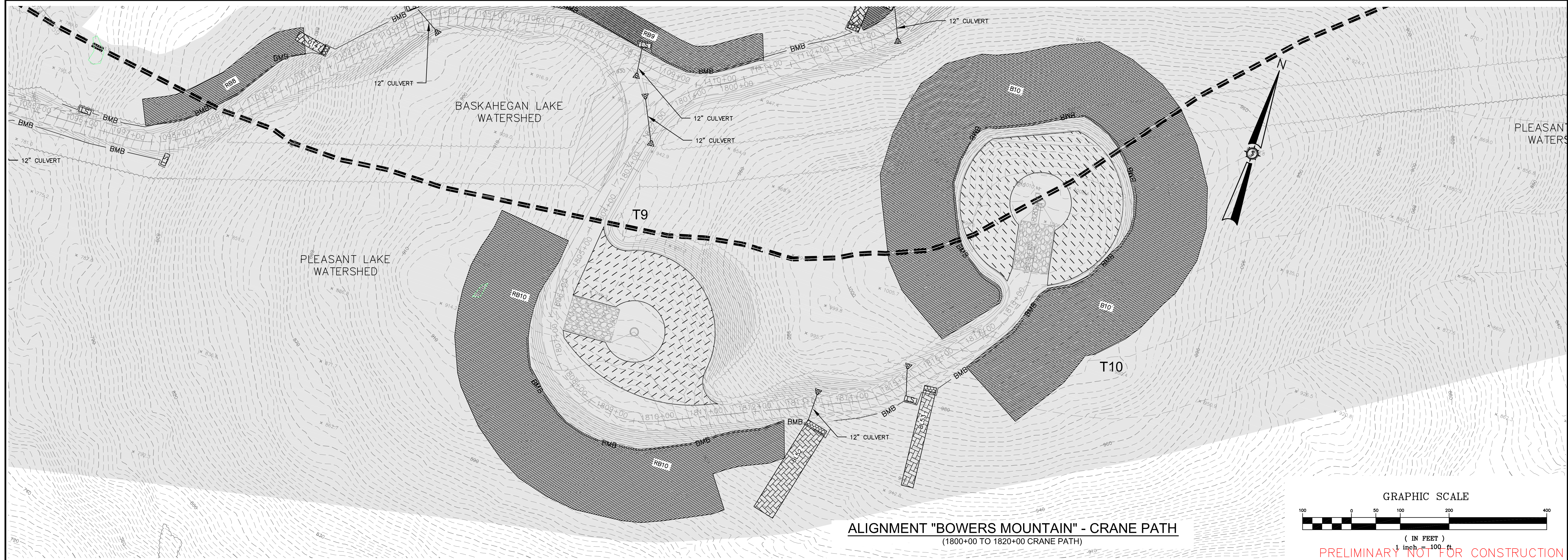
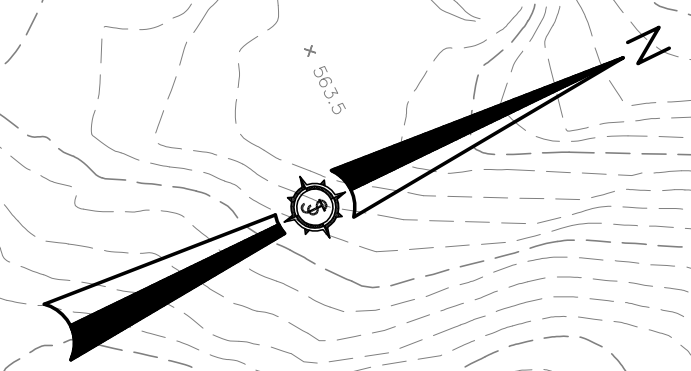
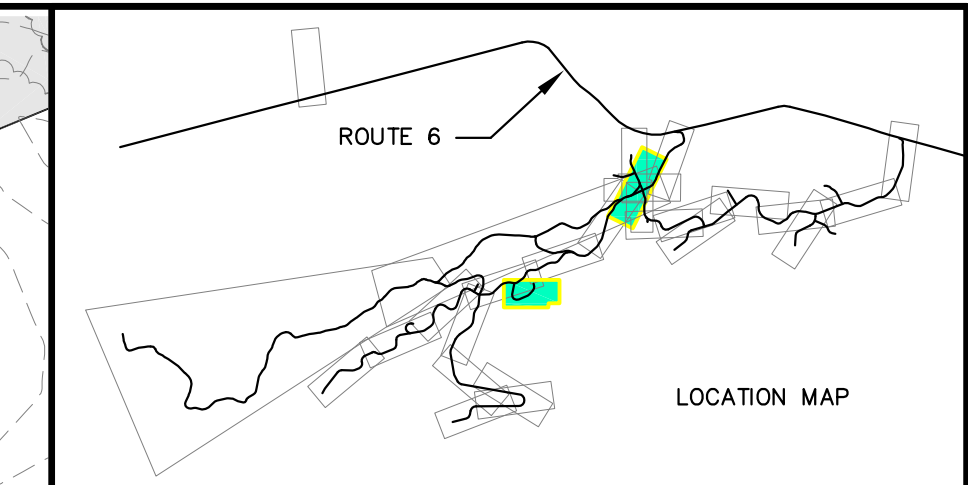
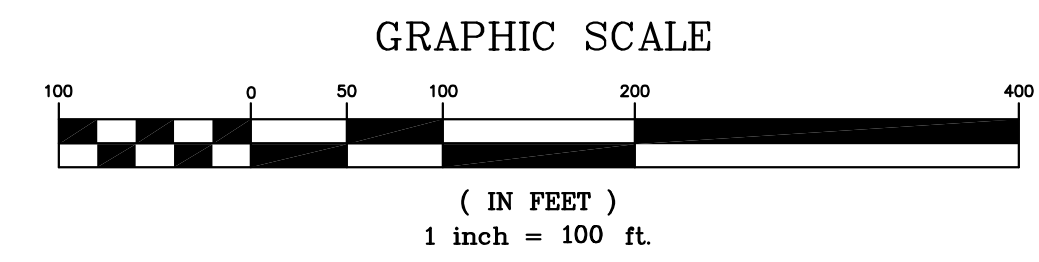

ALIGNMENT "BOWERS MOUNTAIN" - CRANE PATH
 (1800+00 TO 1820+00 CRANE PATH)

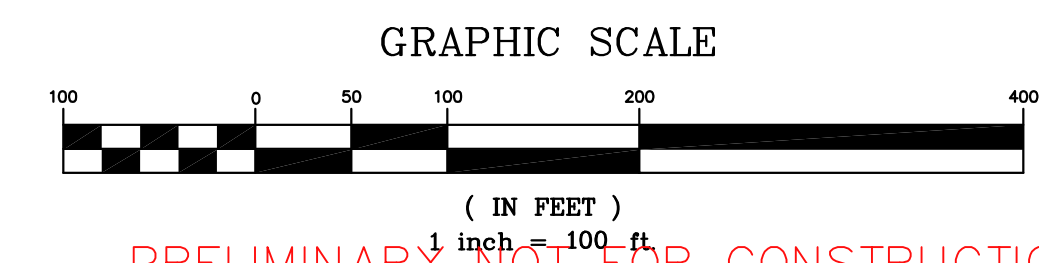

PRELIMINARY NOT FOR CONSTRUCTION

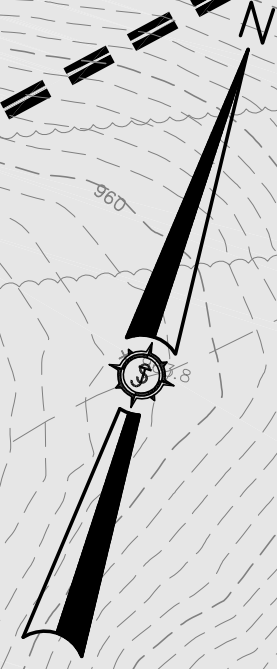

Drawn By	JSM	Date	3/1/2011
Checked By			
Reviewed By			
Issued For Agency Review			

BOWERS WIND PROJECT	
Designed By	JAO
Drawn By	JSM
Date	MARCH 2011
Scale	1"=100'
Approved	
Checked	
Project Location CARROLL PLANTATION & KOSSUTH TOWNSHIP, MAINE	
Drawing Description BOWERS MOUNTAIN EROSION CONTROL PLAN	

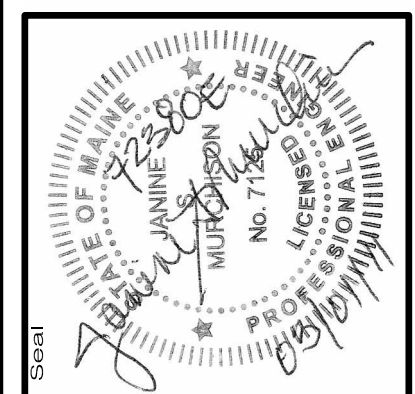

72380E

AN INTEGRATED TEAM OF
 GEOSPATIAL ENGINEERING
 SURVEYING AND NATURAL
 RESOURCE CONSULTANTS

JAMES W. SEWALL COMPANY Since 1880
 SEWALL.COM 800.648.4202

Project No. 72380E

Phase **PERMIT**

Sheet No. **603**